





INTRODUCTION

Fiscal year 2021-22 represents another year profoundly impacted by the COVID-19 pandemic. While Josephine Community Library continued to shift and pivot services in response to community needs, library usage waxed and waned depending on the level of facility restrictions due to statewide mandates. The pandemic continued to affect every aspect of library service. Library statistics, such as circulation and turnover rates, program attendance and participation, and public computer usage should be viewed through this lens.

In Josephine County, residents are served by Josephine Community Library District, formed in May 2017 as a special library district as defined by ORS 357. In its third complete year of operations, the district continued to provide stable library funding with new programs, improved materials, integrated technology, new media, digital inclusion, and information literacy support.

STRATEGIC PLAN

A strategic plan is the overarching document that guides library operations, including mission, vision, values, goals, projects, and key performance indicators. In FY22, the library fulfilled its first year of a three-year the 2021- 2024 Strategic Plan established in April 2021.

Four areas describe the focus of the library's strategic plan and include:

- **Basic Needs:** Residents fulfill basic needs and gain life skills through library services, library partner services, and referrals to community resources.
- **Diverse Perspectives:** Residents of diverse backgrounds have their information needs addressed equitably, their perspectives welcomed, and their group represented at the library.
- **Civic Engagement:** Residents have the information and learning opportunities they need to participate in local, state, and national issues and decision-making.
- **Library Systems:** Residents benefit from a well-managed library that employs efficient operating systems and structures.



STRATEGIC PLAN OUTCOMES

As part of its commitment to supporting the basic needs of Josephine County residents, the library developed and maintained its online community resource database, called JosephineLINK, refining its criteria and promoting the resource through partners and local media. As a result, the library reported a 28 percent increase in access to the community database in FY21-22.

Other notable strategic plan outcomes include:

- Learning the information needs of Spanish-speaking community members by networking with Josephine County agencies and organizations for the monthly Latinx Interagency Network Coalition, hosting a monthly Spanish-language parent support group in partnership with Project Youth+ and SO Health-E.
- Hosting a three-month civics program featuring titled Everyday Civics, providing opportunities to engage people in community civic life through simple activities for all ages. From journalism and democracy to intellectual freedom and emergency preparedness, more than 300 residents participated in the program, resulting in a 1,000 percent increase in use of the library's online civics resources and a 26 percent increase in the checkout of materials from civics displays.
- Developing and maintaining online subject guides to support community information needs including emergency resources, neurodiversity, local history, LGBTQ+, and more.
- Board of directors, staff, volunteers, and partners participated in library science training in cultural competency facilitated by Dr. Michele Villagran with CulturalCo.

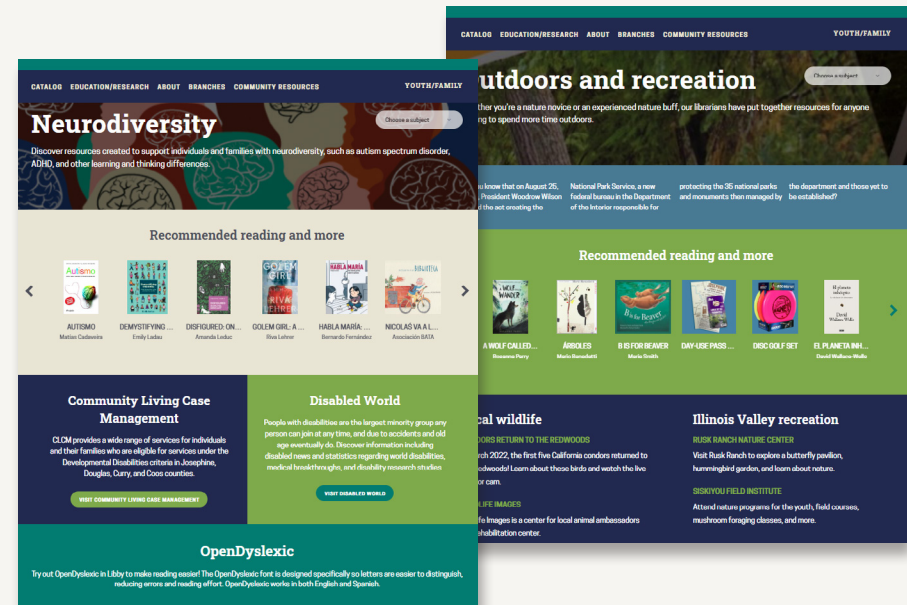

PROGRAMS AND SERVICES

In FY21-22, the library increased its in-person programming as recovery from pandemic allowed facilities to open for six months out of the fiscal year, a significant increase from FY20-21. With this change, statistical information demonstrated that open facilities and in-person programming directly impact library usage, such that electronic resources may serve as a supplement to regular services rather than a replacement – print books and family programs remain in demand and relevant to residents of Josephine County.



Number of Items Borrowed

	FY18	FY19	FY20	FY21	FY22
Grants Pass	199,509	210,921	199,329	68,284	152,080
Illinois Valley	36,862	38,520	32,891	26,804	27,087
Williams	11,350	10,470	8,337	3,708	8,365
Wolf Creek	7,522	8,258	6,236	7,099	6,843
Total	251,768	268,169	246,793	105,895	194,372

*COVID-19 facilities restrictions began March 2020

*FY21 facilities restricted 11 months with full access reinstated June 2021

*FY22 facilities restricted 6 months with full access reinstated January 2022

Figure 1: Monthly and annual circulation of materials decreased significantly due to facilities restrictions. Data does not include ebook borrowing.

Annual E-book and E-audiobook Circulation Compared

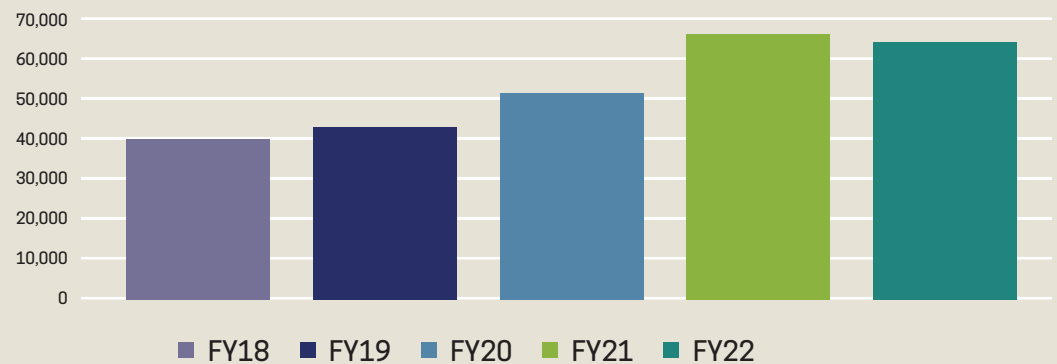

*Total Overdrive consortium ebook checkouts: 54,958

*Advantage JCLD-owned ebook checkouts: 6,764

Note FY20-21 Annual Report graphical chart data was incorrect for FY21 *

Figure 2: In FY21-22, the district loaned 54,958 ebooks, representing a slight decrease of 1 percent.



EARLY LITERACY

After two years of facilities restriction, in June the library offered its 2022 Summer Reading Program in person at all four branches. Participation in the program more than doubled with a reported 650 participants, a significant increase from the 300 the year prior. The library partnered with the Grants Pass Daily Courier again this year to deliver information about the Summer Reading Program to families across Josephine County. Participants also tracked their reading minutes, recoding 220,000 minutes read!

In FY21-22, the library launched the Kindergarten Toolbox program with grant funding from The Ford Family Foundation. Children ages 3–6 and their caregivers received a toolbox with school supplies and met each week for six weeks to learn pre-Kindergarten basic skills. The program filled immediately for the first session with subsequent waiting lists for the next two sessions during the year.

Youth programs totaled 148 programs with 6,004 participants recorded.





LIFELONG LEARNING

As curbside service remained in place for six months of the fiscal year, the library continued to offer virtual programs, such as book clubs and an extremely popular amateur radio series featuring classes leading to licensure in Ham Radio. With cautious optimism, in-person library events resumed in March 2022.

In partnership with 23 local businesses, the library hosted a Storybook Walk in both downtown Grants Pass and Cave Junction, featuring William Wordsworth's famous poem, "I Wandered Lonely as a Cloud." Business owners displayed each stanza of the poem in the windows of downtown businesses which directed participants through an outdoor reading and walking experience.

Total adult programs, both virtual and in person, equaled 34 with 669 participants.



Storybook Walk: Page 1 Find Page 1 at
Cultural Plaza, 208 SW 6th Street

About the Author
William Wordsworth, 1770-1850
 The Josephine Community Library features Storybook Walk because "I Wandered Lonely as a Cloud" by William Wordsworth.

William Wordsworth was an English romantic poet who often wrote about the human relationship to nature. After studying at St. John's College, he set out on a walking tour of Europe, an experience that influenced his poetry. During that time, Wordsworth came into contact with the Romantics which brought about his interest for the life, troubles, and speech of the "ordinary man." These many proved to be most important to Wordsworth's work.

"I Wandered Lonely as a Cloud" was composed in 1805.

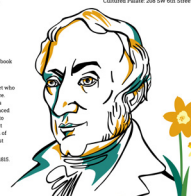

Josephine Community Library For more information about the Storybook Walk or to download the map, visit josephinelibrary.org

Storybook Walk: Page 6 Find Page 6 at
The Kitchen Company, 303 SW 6th Street

What inspired "I Wandered Lonely as a Cloud"?

The bested poem "I Wandered Lonely as a Cloud" is based on one of William Wordsworth's own walks in the countryside of England's Lake District. During the walk, he and his sister encountered a long strip of daffodils. The poem depicts Wordsworth's wandering and discovery of a field of daffodils by a lake, the memory of which proved to be a source of joy when he was lonely, bored, or restless.

The poem is a characteristically romantic poem, bringing together key ideas about imagination, beauty, and the natural world.

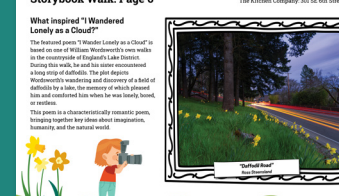

Josephine Community Library For more information about the Storybook Walk or to download the map, visit josephinelibrary.org



TECHNOLOGY AND ONLINE RESOURCES

Today's library users demand more than books and periodicals. All ages of area residents require access to the Internet, computers, and other devices to navigate their lives. The library continued to offer access to 50 highspeed Internet access computers at all four branches with a total of 4,310 logged users, limited only by pandemic facilities restrictions. Patrons also benefited from 48 hotspots available for checkout and an additional 12 laptops with Microsoft Suite for in-home usage.

Throughout the pandemic and beyond, the library's website served as a unique branch of the system providing 21st-Century library services in an ever-changing world. With three complete years of enhanced online services, the library was able to increase website traffic and usage through the addition of Spanish language translation and resources, community organization information, and curated subject guides specific to Josephine County residents' needs.

JCLD Website Engagement

	FY20	FY21	FY22	Notable Change
Visitors	30,551	32,144	43,876	+37%
Page Views	87,750	160,256	167,095	+4%
Sessions	48,685	68,650	78,904	+15%
Spanish Language	22	233	502	+114%
JosephineLINK	n/a	1,724	2,203	+28%



FINANCIAL ADMINISTRATION

Utilizing a budget of \$3 million, the library repaired and replaced the carpet at the Grants Pass branch, increased access to technology, WiFi, and tech support; improved the quality of the collection of materials and programs; and pivoted services in response to the ongoing impact from the COVID-19 pandemic including digital and online resources, curbside service, and virtual programs and storytimes. The district's annual audit was completed in December 2021 with a clean opinion.

FY21 District Expenses

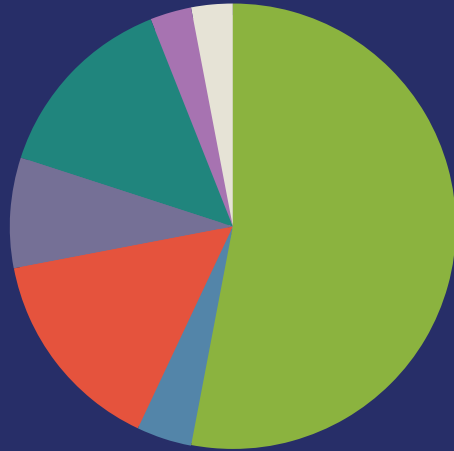

■ Personnel ■ Services ■ Grant Projects ■ Materials
■ Administration ■ Facilities ■ Utilities

FY21 District Revenue

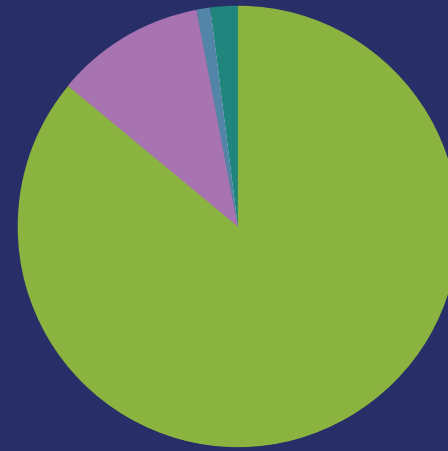

■ Taxes ■ Grants ■ Interest
■ Non-resident Card Fees ■ Other





GRANTS

JCLD seeks grants to fund projects beyond the provision of the standard operations budget. In FY22 grant revenue expended equaled \$211,462. The largest grants received included \$50,000 from The Ford Family Foundation for the Kindergarten Toolbox Project. The complete list of grant funders includes Dorothy Thompson Fund, Federal Communications Commission, Ford Family Foundation, Grants Pass Kiwanis Club, Josephine Community Library Foundation, Josephine County Solid Waste Agency, Josephine County Cultural Coalition, Josephine County Economic Development, Oregon Community Foundation, Oregon Humanities, Oregon Pacific Financial Advisors, and State Library of Oregon.



PARTNERSHIP

The library partnered with local, state, and national nonprofit organizations to offer programs and services which strengthen the district’s mission, increase community engagement, and support community initiatives that align with library core services of providing materials and programs, early literacy, technology, lifelong learning, and open facilities. Library partners fall into three categories – service partners, funding partners, and associations. Service partners are organizations working with the library to provide programs, workshops, storytimes, or other children’s and adult services for community members. Currently the district has 30 service partners, 11 funding partners, and belongs to 13 associations.

Josephine County Parks Department

Josephine Community Library and Josephine County Parks Department have partnered to bring four Day Use Park Passes to the Library of Things. Each kit includes a vehicle park pass and a map illustrating local parks and list of amenities. This addition to the Library of Things collection presents a unique chance to inspire Josephine County residents to recreate at one of the prime day-use locations at no cost.



JOSEPHINE COMMUNITY LIBRARY DISTRICT FY22 SERVICE PARTNERS

- | | |
|--|--------------------------------------|
| Asante Three Rivers Medical Center | Josephine County Public Health |
| Chamber of Commerce | KAJO/KLDR Radio |
| City of Cave Junction | Kiwanis Club of Grants Pass |
| Dolly Parton’s Imagination Library | Latinx Interagency Committee (LINC) |
| Four Rotary Clubs in Josephine County | Literacy Council of Josephine County |
| Foster Grandparents of Southern Oregon | Oregon Humanities |
| Gilder Lehrman Institute of American History | Project Youth+ |
| Grants Pass Daily Courier | Rogue Valley NaNoWriMo |
| Grants Pass Museum of Art | SO Health-E |
| Grants Pass School District 7 | Southern Oregon Amateur Radio Club |
| Illinois Valley Home Schoolers | Sugarloaf Community Association |
| Illinois River Valley Arts Council | Sunny Wolf Charter School |
| Josephine County Cultural Coalition | Three Rivers School District |
| Josephine County Historical Society | Therapy Dogs International |
| Josephine County Parks Department | Williams Community Preschool |



VOLUNTEERS

Library volunteers are critical to the success and community culture of the library system – they are the heart of our library and our community. From re-shelving and shifting materials to cataloging, storytime, and front desk service, library volunteers make it possible for the library to continue operating and thriving year over year. .



JOSEPHINE COMMUNITY LIBRARY FOUNDATION

Josephine Community Library Foundation funds special library projects which are beyond the reach of the library's tax-funded operations budget such as capital projects.

Improving our facilities is critical to the ongoing and future success of the libraries in our community. The district and foundation have established facilities improvement as a top priority.

During FY22, the Capital Campaign Steering Committee was formed. The committee is led by library district and foundation board presidents and comprised of major donors and foundation board members.

As part of the projects defined in the Facilities Master Plan, the library foundation focused on fundraising and planning for three main capital projects: The Illinois Valley Renovation Project, New Williams Library, and New Grants Pass Library Property Purchase.

THANK YOU FOUNDATION BUSINESS SPONSORS

AllCare Health
All Star Towing
Asante
Avista
Cauble, Selvig, and Whittington LLP
Cynthia Harelson, CPA
Edward Jones
Evergreen Bank
Hart Insurance
Herb Pharm
Hill Dentistry
La-Z Boy Furniture

Oregon Books & Games
Oregon Pacific Financial Advisors, Inc.
Republic Services
Robinson Orthodontics
Rogue Law Firm
Robyn Lasky — ReMax Integrity
Sara Reichers, DDS
Shamrock Plumbing
Southern Oregon Sanitation
Susie Matney — J.L. Scott
Welch Investment Group, LLC

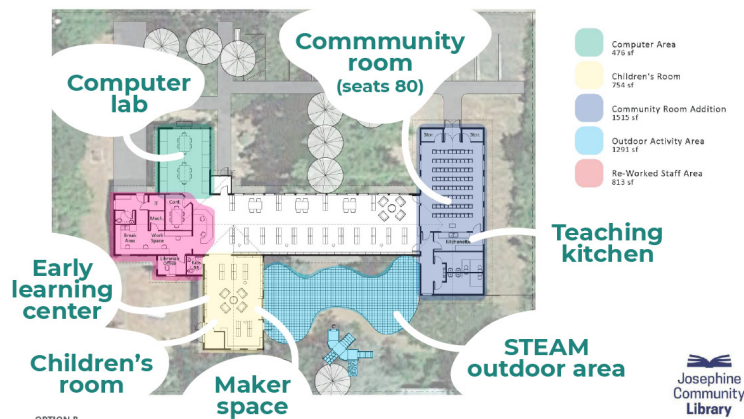

OPTION B
August 5, 2021

ZCS ENGINEERING & ARCHITECTURE

FACILITIES

Recognizing that a library system needs appropriate space – for collections, for people, for programming, and for functional operations – the foundation and the library district have established a partnership to improve facilities.

Illinois Valley

In August of 2021, the foundation launched the New Chapters Crowdfund to raise the additional funds needed to support the renovation. The \$114,000 raised are designated to support the programmatic pieces of the Illinois Valley renovation, including a teaching kitchen in the community room, a Maker Space and early learning center, and an outdoor area set up for STEAM (Science, Technology, Engineering, Art, and Math).

Williams

In June of 2022, the foundation exceeded its goal of raising \$135,000 during the New Williams Library Fundraising Drive. The funds raised during the drive will be used to provide a much-needed restroom and running water for the library, updated technology including hi-speed Internet, more space, and provide a beautiful setting for outdoor programs. The foundation has contracted with ZCS Engineering & Architecture to renovate an existing structure located at 20140 Williams Hwy to become the library, scheduled to be completed in June 2023.

Grants Pass

The foundation currently has an option to purchase a property located between 6th and 7th Streets in downtown Grants Pass by June of 2023. Concept designs propose a community center on a city block between J and K Streets which will help revitalize that section of downtown. Library district and foundation board members, businesses, and community leaders have collectively donated \$574,000 with an additional \$520,000 pledged to the property purchase and continue to find other ways to give including gifts of property, IRA contributions, and more.

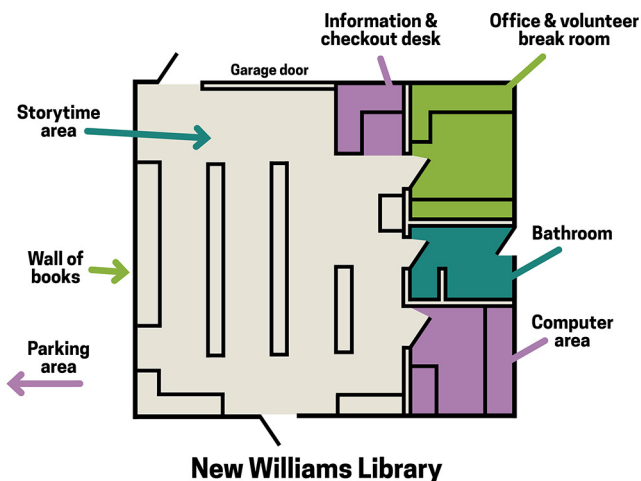



GRANTS PASS

200 NW C St
Grants Pass, OR
541-476-0571

ILLINOIS VALLEY

209 West Palmer
Cave Junction, OR
541-592-4778

WILLIAMS

20695 Williams Hwy
Williams, OR
541-846-7020

WOLF CREEK

102 Ruth Ave
Wolf Creek, OR
541-866-2606

 **Josephine
Community Library**

josephinelibrary.org